

1821 Tábor - Bechyně

km 5,2 - 6,1
k.ú. Radimovice a Slapy

- mezník
- kolík
- o neobnoven

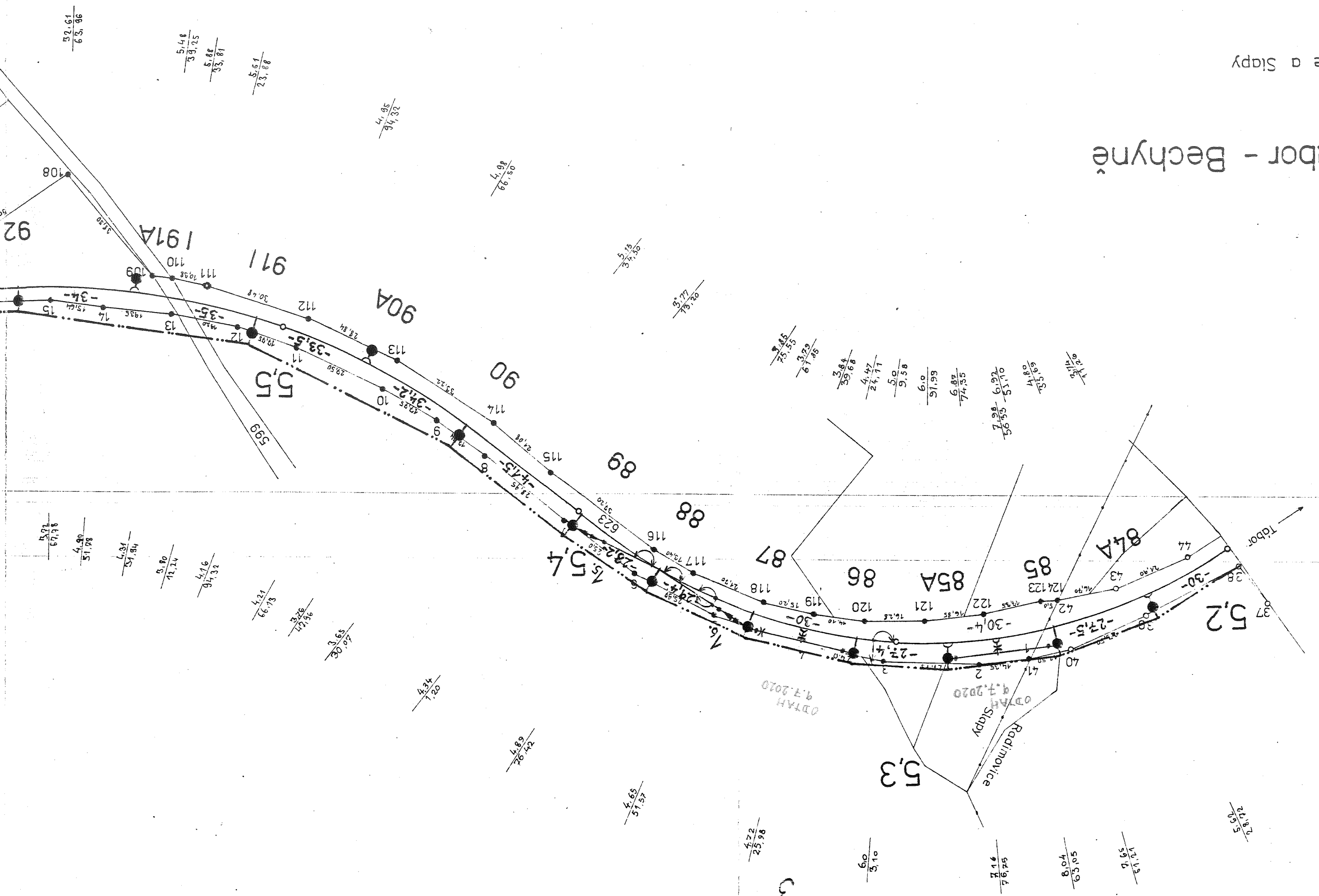

4,82
94,34
6,16
94,90

25,0
60,73

24,26
27,90

38,0
94,85

43,10
75,40

46,05
68,96
4,56
58,10

4,73
92,80

3,94
5,20

4,29
18,30

5,25
4,80

Geom. plan 4110-II-34

zst. Slapy

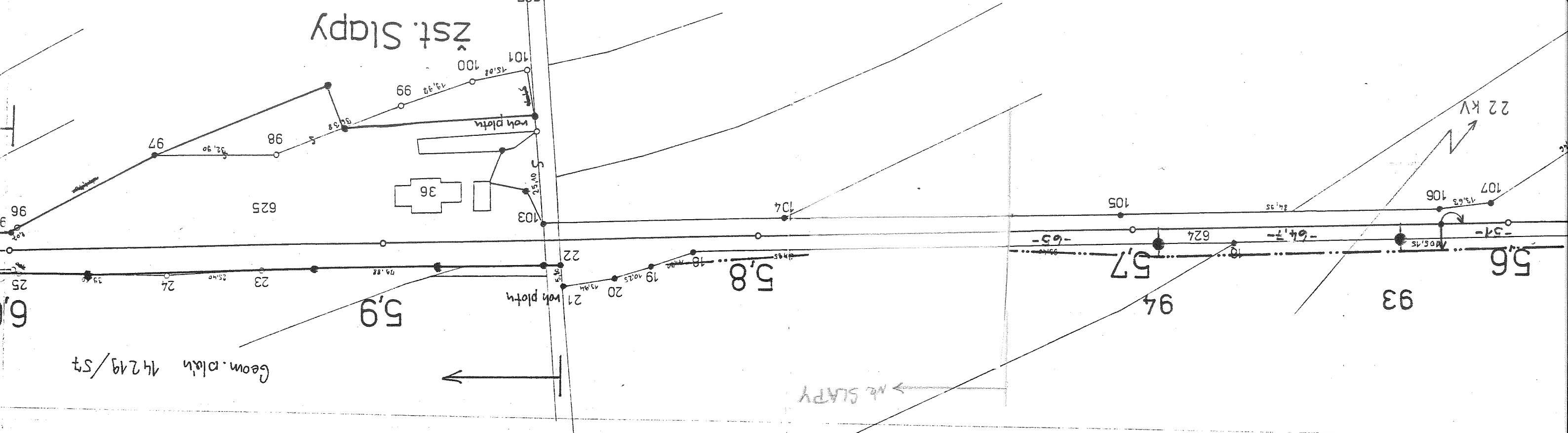

Geom. plan 14249/S7

5,9

5,8

5,7

5,6

93

94

no Slapy

$$\begin{array}{r} 1,82 \\ 94,34 \\ \hline 96,16 \end{array}$$

$$\begin{array}{r} 4,36 \\ 42,58 \\ \hline 46,94 \end{array}$$

$$\begin{array}{r} 5,42 \\ 72,56 \\ \hline 77,98 \end{array}$$

$$\begin{array}{r} 5,27 \\ 7,25 \\ \hline 12,52 \end{array}$$

$$\begin{array}{r} 6,13 \\ 92,93 \\ \hline 99,06 \end{array}$$

$$\begin{array}{r} 1,11 \\ 5,15 \\ \hline 6,26 \end{array}$$

$$\begin{array}{r} 1,16 \\ 5,50 \\ \hline 6,66 \end{array}$$

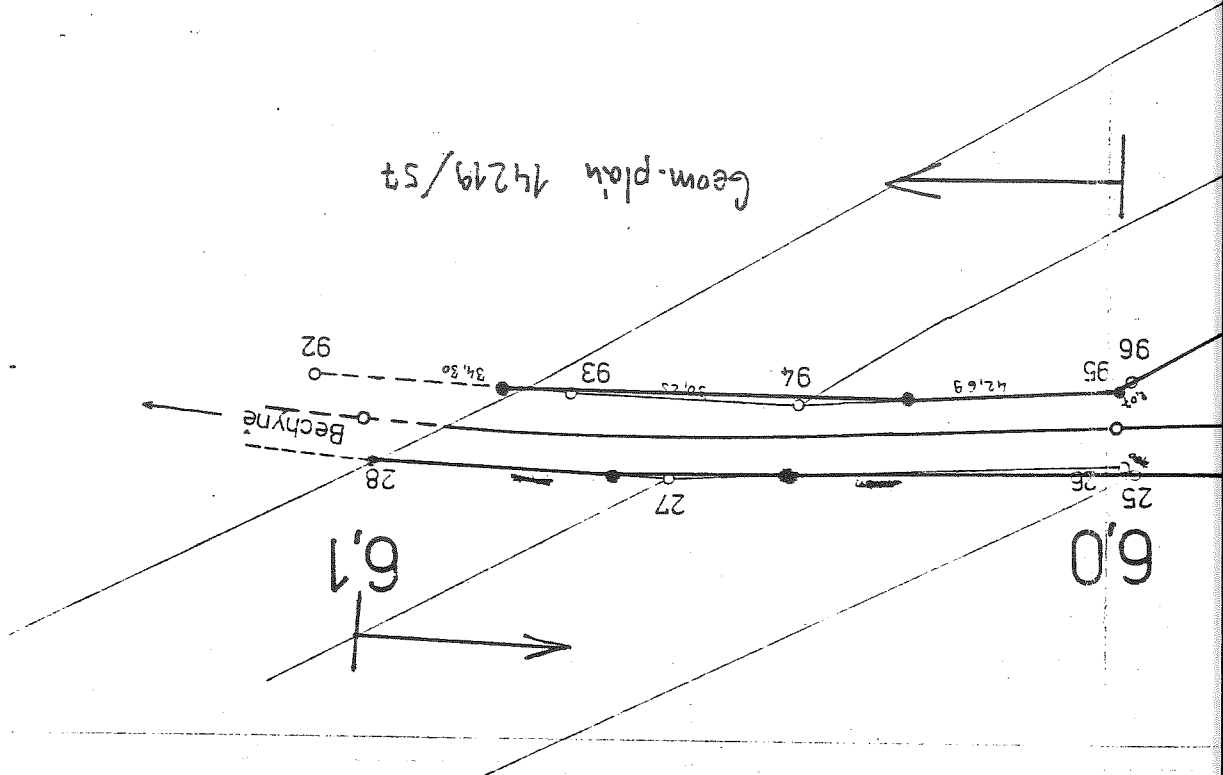

Geom. plan 14219/54

Bechyně